

110AH



合金钢；吊秤专用；符合 级秤要求



Capacity ≤ 20t Cable φ 5.1 × 3m
Capacity ≥ 30t Cable φ 5.1 × 10m

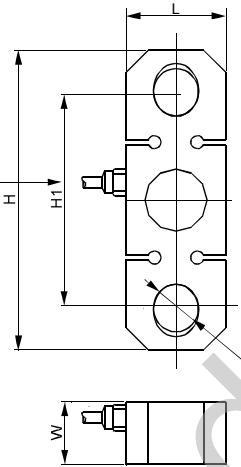

CE RoHS IP 67

尺寸

量程	C	H	H1	L	W
kg/mm					
2,000	20.0	145.0	95.0	50.0	15.0
5,000	25.0	145.0	100.0	45.0	28.2
10,000	33.4	184.0	120.0	60.0	38.0
20,000	44.0	244.0	165.0	85.0	55.0
30,000	52.0	318.0	220.0	112.0	66.0
50,000	70.0	436.0	294.0	140.0	88.0
80,000...120,000	120.0	705.0	475.0	240.0	120.0
lb/inches (由上述尺寸转换)					
4,409.2	0.79	5.71	3.74	1.97	0.59
11,023.1	0.98	5.71	3.94	1.77	1.11
22,046.2	1.31	7.24	4.72	2.36	1.50
44,092.5	1.73	9.60	6.50	3.37	2.17
66,138.7	2.05	12.52	8.66	4.41	2.60
110,231.1	2.76	17.17	11.57	5.51	3.46
176,369.8...264,554.7	4.72	27.76	18.70	9.45	4.72

技术参数

相关量程	kg	2t	5t	10t	20t	30t	50t	80t	120t
产品毛重	kg/lb	0.8 / 1.9	1.2 / 2.5	2.5 / 5.5	7.4 / 16.3	16 / 35.3	40 / 88.2	-	-
灵敏度	mV/V	2 ± 10%							
零位输出	mV/V	± 0.05							
非线性	%	< ± 0.017							
重复性	%	< ± 0.017							
滞后误差	%	< ± 0.017							
蠕变	%	< ± 0.023							
阻抗	Ω	350 ± 3							
额定激励电压	V(DC/AC)	12 (18V 最大)							
绝缘阻抗	GΩ	> 2 [50 VDC]							
正常工作温度范围	°C/°F	-10...40 / 14...104							
安全极限载荷	% of full scale	200							
破坏极限载荷	% of full scale	400							
密封方式		密封, IP67							

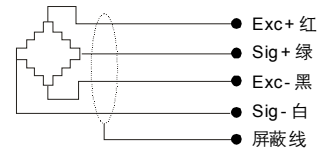

拉板式称重传感器